

Modular system

ACO Spin flat roof drains made of stainless steel for gravity drainage

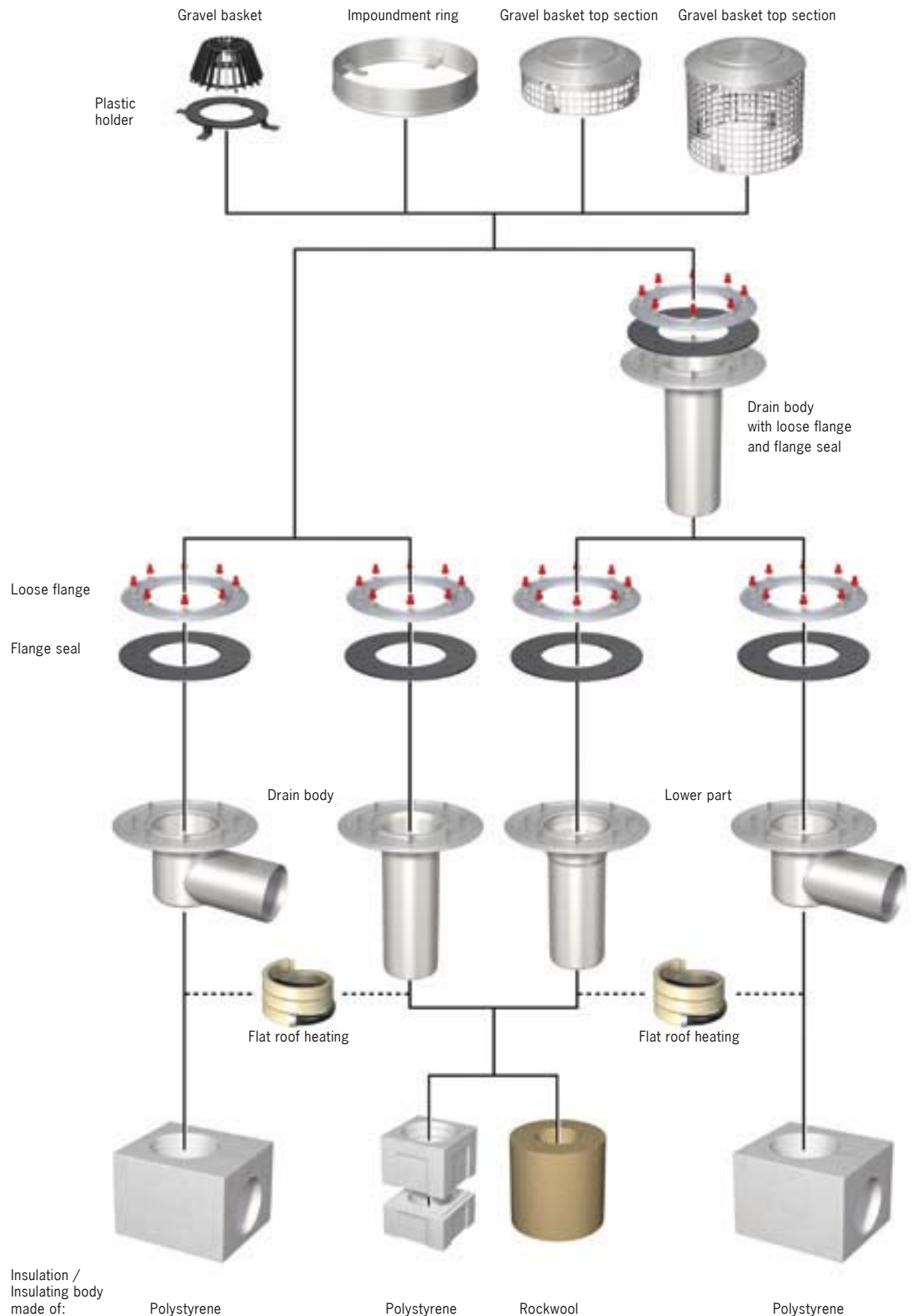

## ACO Spin flat roof drains made of stainless steel with vertical outlet socket

### DN 70 – DN 125

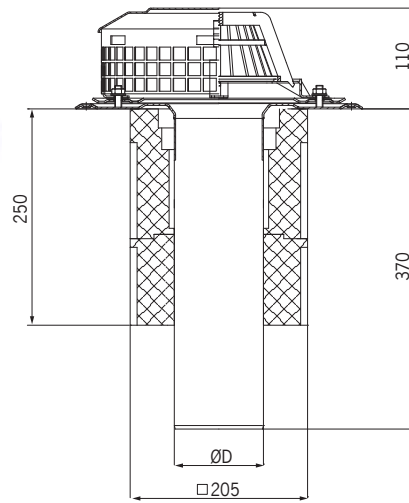

- Flat roof drain DN 70 – DN 125 with vertical outlet socket pursuant to DIN EN 1253
- Stainless steel, material 1.4301
- With compression sealing flange for sealing one sealing membrane  
**Warning! It is NOT possible to install a second sealing membrane after the vertical drain has been installed!**
- Optionally available with a gravel basket made of plastic or stainless steel.
- Optionally available uninsulated, insulated with polystyrene or rock wool, and optionally with/without heating.
- Direct connection to ACO GM-X pipe system, connection to other types of pipe require transition fittings, see page 162 and 163.

Nominal width	Stainless steel gravel basket				Plastic gravel basket		
	Model	Weight	D	Article No.	Weight	D	Article No.
DN 70	uninsulated	4,5	73	<b>1179.10.60</b>	3,7	73	<b>1179.10.10</b>
	insulated, polystyrene	4,7	73	<b>1179.15.60</b>	3,9	73	<b>1179.15.10</b>
	insulated, rock wool	4,7	73	<b>1179.17.60</b>	3,9	73	<b>1179.17.10</b>
	insulated, polystyrene, heated	4,9	73	<b>1179.15.90</b>	4,1	73	<b>1179.15.40</b>
	insulated, rock wool, heated	4,9	73	<b>1179.17.90</b>	4,1	73	<b>1179.17.40</b>
DN 100	uninsulated	4,9	103	<b>1119.10.60</b>	4,1	103	<b>1119.10.10</b>
	insulated, polystyrene	5,0	103	<b>1119.15.60</b>	4,2	103	<b>1119.15.10</b>
	insulated, rock wool	5,0	103	<b>1119.17.60</b>	4,2	103	<b>1119.17.10</b>
	insulated, polystyrene, heated	5,2	103	<b>1119.15.90</b>	4,4	103	<b>1119.15.40</b>
	insulated, rock wool, heated	5,2	103	<b>1119.17.90</b>	4,4	103	<b>1119.17.40</b>
DN 125	uninsulated	5,9	133	<b>1129.10.60</b>	5,1	133	<b>1129.10.10</b>
	insulated, polystyrene	6,0	133	<b>1129.15.60</b>	5,2	133	<b>1129.15.10</b>
	insulated, rock wool	6,0	133	<b>1129.17.60</b>	5,2	133	<b>1129.17.10</b>
	insulated, polystyrene, heated	6,2	133	<b>1129.15.90</b>	5,4	133	<b>1129.15.40</b>
	insulated, rock wool, heated	6,2	133	<b>1129.17.90</b>	5,4	133	<b>1129.17.40</b>

#### Core borehole dimensions

Nominal width	Ø a	Ø c	b [mm]
<b>For drain bodies without insulating bodies</b>			
DN 70	340	90	10
DN 100	340	130	10
DN 125	340	160	10
<b>For drain bodies with insulating bodies</b>			
DN 70	340	290	10
DN 100	340	290	10
DN 125	340	290	10

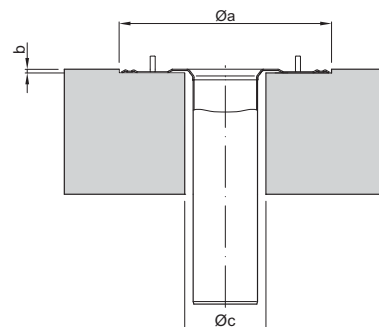

#### Recess dimensions

Nominal width	Type	Inclination	Recess dimensions drain body without insulating body	Recess dimensions drain body with insulating body
DN 70	Spin	90°	120 x 260 mm	230 x 360 mm
DN 100	Spin	90°	150 x 290 mm	230 x 360 mm
DN 125	Spin	90°	190 x 300 mm	230 x 360 mm

## ACO Spin flat roof drains made of stainless steel with vertical outlet socket

### DN 70 – DN 125

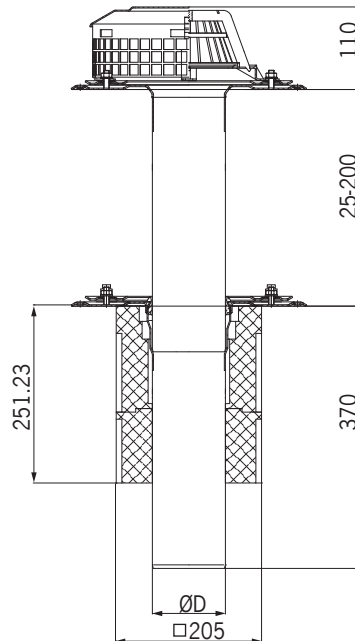

- Flat roof drain DN 70 – DN 125 with vertical outlet socket pursuant to DIN EN 1253
- Stainless steel, material 1.4301
- With two compression sealing flanges for sealing with two sealing membranes
- Optionally available with a gravel basket made of plastic or stainless steel.
- Optionally available uninsulated, insulated with polystyrene or rock wool, and optionally with/without heating.
- Direct connection to ACO GM-X pipe system, connection to other types of pipe require transition fittings, see page 162 and 163.

Nominal width	Stainless steel gravel basket				Plastic gravel basket		
	Model	Weight	D	Article No.	Weight	D	Article No.
DN 70	uninsulated	7,3	73	<b>1179.20.60</b>	6,4	73	<b>1179.20.10</b>
	insulated, polystyrene	8,4	73	<b>1179.25.60</b>	6,5	73	<b>1179.25.10</b>
	insulated, rock wool	8,4	73	<b>1179.27.60</b>	6,5	73	<b>1179.27.10</b>
	insulated, polystyrene, heated	8,6	73	<b>1179.25.90</b>	6,7	73	<b>1179.25.40</b>
	insulated, rock wool, heated	8,6	73	<b>1179.27.90</b>	6,7	73	<b>1179.27.40</b>
DN 100	uninsulated	7,9	103	<b>1119.20.60</b>	7,0	103	<b>1119.20.10</b>
	insulated, polystyrene	8,2	103	<b>1119.25.60</b>	7,1	103	<b>1119.25.10</b>
	insulated, rock wool	8,2	103	<b>1119.27.60</b>	7,1	103	<b>1119.27.10</b>
	insulated, polystyrene, heated	8,4	103	<b>1119.25.90</b>	7,3	103	<b>1119.25.40</b>
	insulated, rock wool, heated	8,4	103	<b>1119.27.90</b>	7,3	103	<b>1119.27.40</b>
DN 125	uninsulated	9,5	133	<b>1129.20.60</b>	8,6	133	<b>1129.20.10</b>
	insulated, polystyrene	9,6	133	<b>1129.25.60</b>	8,8	133	<b>1129.25.10</b>
	insulated, rock wool	9,6	133	<b>1129.27.60</b>	8,8	133	<b>1129.27.10</b>
	insulated, polystyrene, heated	9,8	133	<b>1129.25.90</b>	9,0	133	<b>1129.25.40</b>
	insulated, rock wool, heated	9,8	133	<b>1129.27.90</b>	9,0	133	<b>1129.27.40</b>

#### Core borehole dimensions

Nominal width	Ø a	Ø c	b [mm]
<b>For drain bodies without insulating bodies</b>			
DN 70	340	90	10
DN 100	340	130	10
DN 125	340	160	10
<b>For drain bodies with insulating bodies</b>			
DN 70	340	290	10
DN 100	340	290	10
DN 125	340	290	10

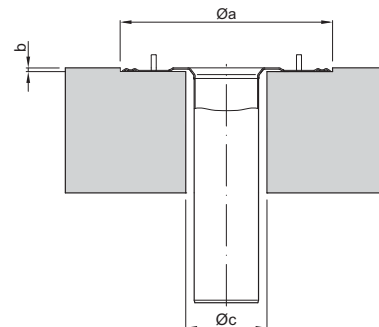

#### Recess dimensions

Nominal width	Type	Inclination	Recess dimensions drain body without insulating body	Recess dimensions drain body with insulating body
DN 70	Spin	90°	120 x 260 mm	230 x 360 mm
DN 100	Spin	90°	150 x 290 mm	230 x 360 mm
DN 125	Spin	90°	190 x 300 mm	230 x 360 mm

## ACO Spin flat roof drains made of stainless steel with lateral outlet socket

### DN 70 – DN 125



- Flat roof drain DN 70 – DN 125 with lateral outlet socket pursuant to DIN EN 1253
- Stainless steel, material 1.4301
- With compression sealing flange for sealing one sealing membrane
- Optionally available with a gravel basket made of plastic or stainless steel.
- Optionally available uninsulated, insulated with polystyrene or rock wool, and optionally with/without heating.
- Direct connection to ACO GM-X pipe system, connection to other types of pipe require transition fittings, see page 162 and 163.

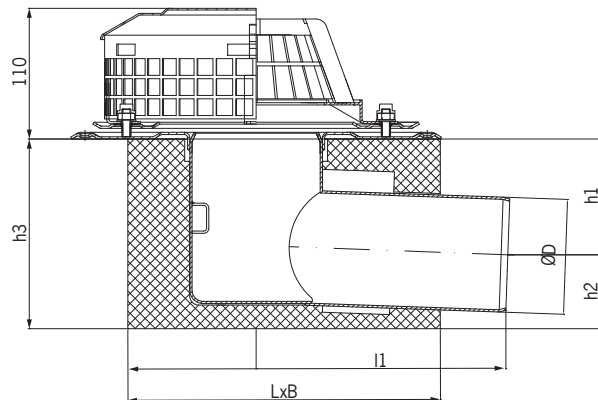

L x B = DN 70: 260 x 190  
DN 100/125: 280 x 230

Nominal width	Model	Stainless steel gravel basket		Plastic gravel basket		D	h1	h2	h3	l1
		Weight	Article No.	Weight	Article No.					
DN 70	uninsulated	4,4	<b>1175.10.60</b>	3,7	<b>1175.10.10</b>	73	95	118	140	213
	insulated, polystyrene	4,6	<b>1175.15.60</b>	3,9	<b>1175.15.10</b>	73	95	118	140	213
	insulated, rock wool	4,6	<b>1175.17.60</b>	3,9	<b>1175.17.10</b>	73	95	118	140	213
	insulated, polystyrene, heated	4,8	<b>1175.15.90</b>	4,1	<b>1175.15.40</b>	73	95	118	140	213
	insulated, rock wool, heated	4,8	<b>1175.17.90</b>	4,1	<b>1175.17.40</b>	73	95	118	140	213
DN 100	uninsulated	4,9	<b>1115.10.60</b>	4,1	<b>1115.10.10</b>	103	104	148	170	226
	insulated, polystyrene	5,1	<b>1115.15.60</b>	4,2	<b>1115.15.10</b>	103	104	148	170	226
	insulated, rock wool	5,1	<b>1115.17.60</b>	4,2	<b>1115.17.10</b>	103	104	148	170	226
	insulated, polystyrene, heated	5,3	<b>1115.15.90</b>	4,4	<b>1115.15.40</b>	103	104	148	170	226
	insulated, rock wool, heated	5,3	<b>1115.17.90</b>	4,4	<b>1115.17.40</b>	103	104	148	170	226
DN 125	uninsulated	5,6	<b>1125.10.60</b>	5,1	<b>1125.10.10</b>	133	124	178	200	230
	insulated, polystyrene	5,8	<b>1125.15.60</b>	5,2	<b>1125.15.10</b>	133	124	178	200	230
	insulated, rock wool	5,8	<b>1125.17.60</b>	5,2	<b>1125.17.10</b>	133	124	178	200	230
	insulated, polystyrene, heated	6,0	<b>1125.15.90</b>	5,4	<b>1125.15.40</b>	133	124	178	200	230
	insulated, rock wool, heated	6,0	<b>1125.17.90</b>	5,4	<b>1125.17.40</b>	133	124	178	200	230

#### Recess dimensions

Nominal width	Type	Inclination	Recess dimensions drain body without insulating body	Recess dimensions drain body with insulating body
DN 70	Spin	1,5°	120 x 360 mm	220 x 360 mm
DN 100	Spin	1,5°	150 x 400 mm	260 x 430 mm
DN 125	Spin	1,5°	190 x 400 mm	260 x 430 mm

## ACO Spin flat roof drains made of stainless steel with lateral outlet socket DN 70 – DN 125

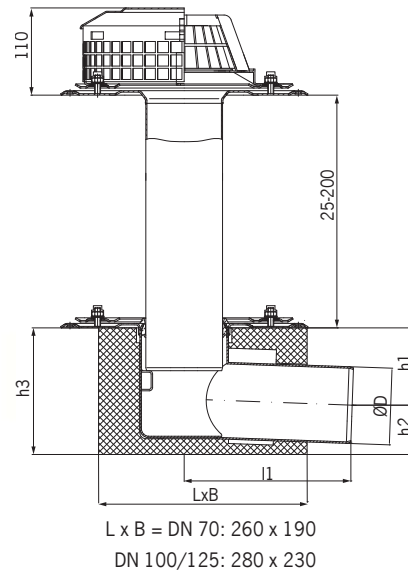

- Flat roof drain DN 70 – DN 125 with lateral outlet socket pursuant to DIN EN 1253
- Stainless steel, material 1.4301
- With two compression sealing flanges for sealing with two sealing membranes
- Optionally available with a gravel basket made of plastic or stainless steel.
- Optionally available uninsulated, insulated with polystyrene or rock wool, and optionally with/without heating.
- Direct connection to ACO GM-X pipe system, connection to other types of pipe require transition fittings, see page 162 and 163.







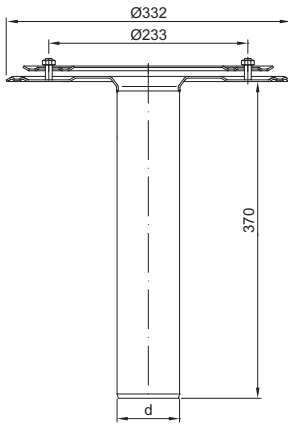

Nominal width	Model	Stainless steel gravel basket		Plastic gravel basket		D	h1	h2	h3	l1
		Weight	Article No.	Weight	Article No.					
DN 70	uninsulated	7,2	<b>1175.20.60</b>	6,5	<b>1175.20.10</b>	73	95	118	140	213
	insulated, polystyrene	7,4	<b>1175.25.60</b>	6,7	<b>1175.25.10</b>	73	95	118	140	213
	insulated, rock wool	7,4	<b>1175.27.60</b>	6,7	<b>1175.27.10</b>	73	95	118	140	213
	insulated, polystyrene, heated	7,6	<b>1175.25.90</b>	6,9	<b>1175.25.40</b>	73	95	118	140	213
	insulated, rock wool, heated	7,6	<b>1175.27.90</b>	6,9	<b>1175.27.40</b>	73	95	118	140	213
DN 100	uninsulated	7,9	<b>1115.20.60</b>	7,1	<b>1115.20.10</b>	103	104	148	170	226
	insulated, polystyrene	8,1	<b>1115.25.60</b>	7,3	<b>1115.25.10</b>	103	104	148	170	226
	insulated, rock wool	8,1	<b>1115.27.60</b>	7,3	<b>1115.27.10</b>	103	104	148	170	226
	insulated, polystyrene, heated	8,2	<b>1115.25.90</b>	7,5	<b>1115.25.40</b>	103	104	148	170	226
	insulated, rock wool, heated	8,2	<b>1115.27.90</b>	7,5	<b>1115.27.40</b>	103	104	148	170	226
DN 125	uninsulated	9,2	<b>1125.20.60</b>	8,4	<b>1125.20.10</b>	133	124	178	200	230
	insulated, polystyrene	9,4	<b>1125.25.60</b>	8,6	<b>1125.25.10</b>	133	124	178	200	230
	insulated, rock wool	9,4	<b>1125.27.60</b>	8,6	<b>1125.27.10</b>	133	124	178	200	230
	insulated, polystyrene, heated	9,6	<b>1125.25.90</b>	8,8	<b>1125.25.40</b>	133	124	178	200	230
	insulated, rock wool, heated	9,6	<b>1125.27.90</b>	8,8	<b>1125.27.40</b>	133	124	178	200	230

### Recess dimensions

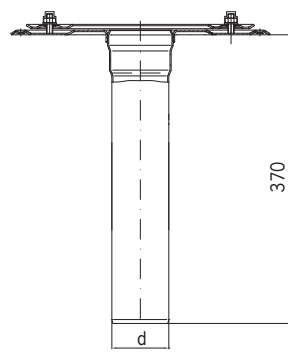

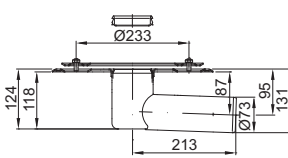
Nominal width	Type	Inclination	Recess dimensions drain body without insulating body	Recess dimensions drain body with insulating body
DN 70	Spin	90°	120 x 360 mm	220 x 360 mm
DN 100	Spin	90°	150 x 400 mm	260 x 430 mm
DN 125	Spin	90°	190 x 400 mm	260 x 430 mm

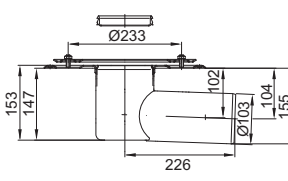
## Additional components

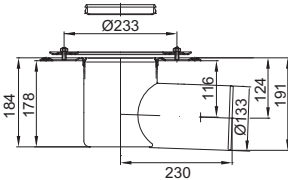
## ACO Spin flat roof drains DN 70 – DN 125 made of stainless steel

	Scale drawing	Product description	Model	Article No.
		<b>Drain body for a one-piece or two-piece flat roof drain with vertical or horizontal outlet socket</b> stainless steel, material 1.4301, with compression sealing flange.  <b>Warning! No extension piece for a second sealing membrane level can be installed after installation!</b>	DN 70 (d= 73 mm)  DN 100 (d= 103 mm)  DN 125 (d= 133 mm)	<b>0174.47.30</b>  <b>0174.47.31</b>  <b>0174.47.32</b>
		<b>Lower part for two-piece flat roof drain</b> stainless steel, material 1.4301 with compression sealing flange	DN 70 (d= 73 mm)  DN 100 (d= 103 mm)  DN 125 (d= 133 mm)	<b>0174.47.15</b>  <b>0174.47.16</b>  <b>0174.47.17</b>
		<b>Drain body/lower part for one-piece or two-piece flat roof drain with lateral outlet socket</b> stainless steel, material 1.4301, with compression sealing flange	DN 70 (d= 73 mm)	<b>0174.48.03</b>
		<b>Drain body/lower part for one-piece or two-piece flat roof drain with lateral outlet socket</b> stainless steel, material 1.4301, with compression sealing flange	DN 100 (d= 103 mm)	<b>0174.48.04</b>
		<b>Drain body/lower part for one-piece or two-piece flat roof drain with lateral outlet socket</b> stainless steel, material 1.4301, with compression sealing flange	DN 125 (d= 133 mm)	<b>0174.48.11</b>

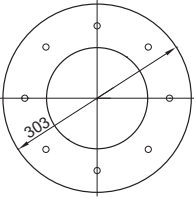
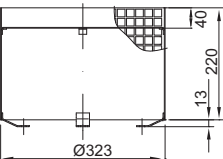
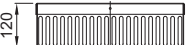
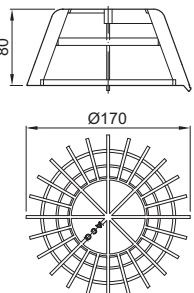







		Scale drawing	Product description	Model	Article No.
Contents			<b>Positioning flange</b> with compression sealing flange, stainless steel, material 1.4301, for lower parts DN 70 in the Spin product line	For unheated model	<b>0174.46.53</b>
			For heated model	<b>0174.46.54</b>	
Gravity drainage			<b>Flange seal</b>	EPDM, thickness: 4 mm	<b>0174.42.87</b>
			EPDM, thickness: 5 mm	<b>0174.42.95</b>	
			PVC-soft, thickness: 4 mm	<b>0174.42.92</b>	
			NBR/SBR, thickness: 4 mm	<b>0174.42.97</b>	
Syphonic drainage			<b>Gravel basket</b> stainless steel, fits all Spin flat roof drains made of stainless steel	Height: 75 mm	<b>0174.46.59</b>
			Height: 225 mm	<b>0174.46.62</b>	
Parking deck drainage			<b>Gravel basket for reversed roof</b> stainless steel, material 1.4301, load class H 1.5		<b>0153.60.01</b>
Balcony and terrace drainage			<b>Control shaft</b> stainless steel, material 1.4301, dimensions: 400 x 400 mm, height: 120 mm, load class H 1.5		<b>0153.73.05</b>
Facade drainage			<b>Gravel basket made of plastic</b> fits all Spin flat roof drains made of stainless steel, only in combination with the plastic support described below		<b>0174.46.66</b>
Pipe systems			<b>Plastic support</b> for plastic gravel basket		<b>0174.46.67</b>

	Scale drawing	Product description	Model	Article No.
		<b>Impoundment ring stainless steel, material 1.4301</b>	DN 70/DN100, Height: 35 mm	<b>0174.46.76</b>
			DN 125, Height: 45 mm	<b>0174.46.77</b>
		<b>Profiline top section steel, galvanised, dimensions: 400x400 mm height adjustable from 78-108 mm (gratings see page 137 and 138)</b>		<b>38801</b>
		<b>Extension for Profiline top section for frame dimensions 400x400 mm</b>	Height: 30 mm	<b>38685</b>
			Height: 60 mm	<b>38687</b>
			Height: 120 mm	<b>38689</b>
		<b>Flat roof heating</b> fits all flat roof drains DN 70 – DN 150, Electrical supply: 220-240 V, AC, Nominal power: 25 W, Protection class: I, Protection type: IP 67, Cables: SIHF 3 x 1 mm <sup>2</sup> , 1.5 m G 1.5		<b>0174.84.32</b>
		<b>Polystyrene insulation, PS 30</b> for vertical drain bodies Spin and lower parts	DN 70 DN 100 DN 125	<b>0174.47.18</b> <b>0174.47.19</b> <b>0174.47.20</b>
		<b>Rock wool insulation, construction material class A1</b> for all vertical drain bodies Spin and lower parts	DN 70 DN 100	<b>0174.46.57</b> <b>0174.47.21</b>
		<b>Polystyrene insulation, PS 30</b> for lateral lower parts Spin	DN 70, 260x190x140	<b>0174.48.06</b>
			DN 100, 280x230x170	<b>0174.48.07</b>
			DN 125, 280x230x200	<b>0174.48.08</b>
		<b>Mounting sheet for trapezoidal sheet roofs</b> steel, galvanised		<b>0174.46.61</b>

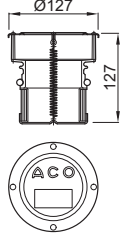

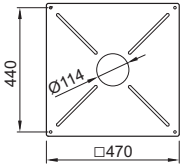
Fire protection accessories

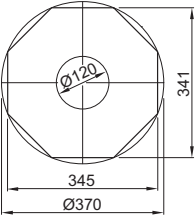
ACO Spin flat roof drains DN 100 made of stainless steel

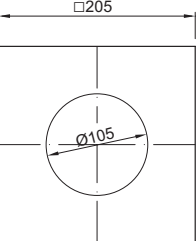
	Scale drawing	Product description	Model	Article No.
		<p><b>Fire protection insert</b> fits Spin flat roof drains DN 100 with 90° outlet socket inclination.</p> <p><i>Warning! The outflow capacity is reduced when this insert is installed (refer to page 15).</i></p>		<b>7034.20.15</b>
		<p><b>Heat shield</b> stainless steel, for Spin flat roof drain DN 100, with impact dowels M8 x 16</p>		<b>7034.20.17</b>
		<p><b>Insulating body</b> foam glass, for Spin vertical drain bodies and lower parts</p>		<b>0174.77.96</b>
		<p><b>Insulating sleeve</b> foam glass, for Spin vertical drain bodies and lower parts for length adaptation (height: 150 mm)</p>		<b>0174.77.94</b>

Contents

Gravity drainage

Syphonic drainage

Parking deck drainage

Balcony and terrace drainage

Facade drainage

Pipe systems

Installation recommendation

Gravity drainage with Attika flat roof gully and duct made of stainless steel

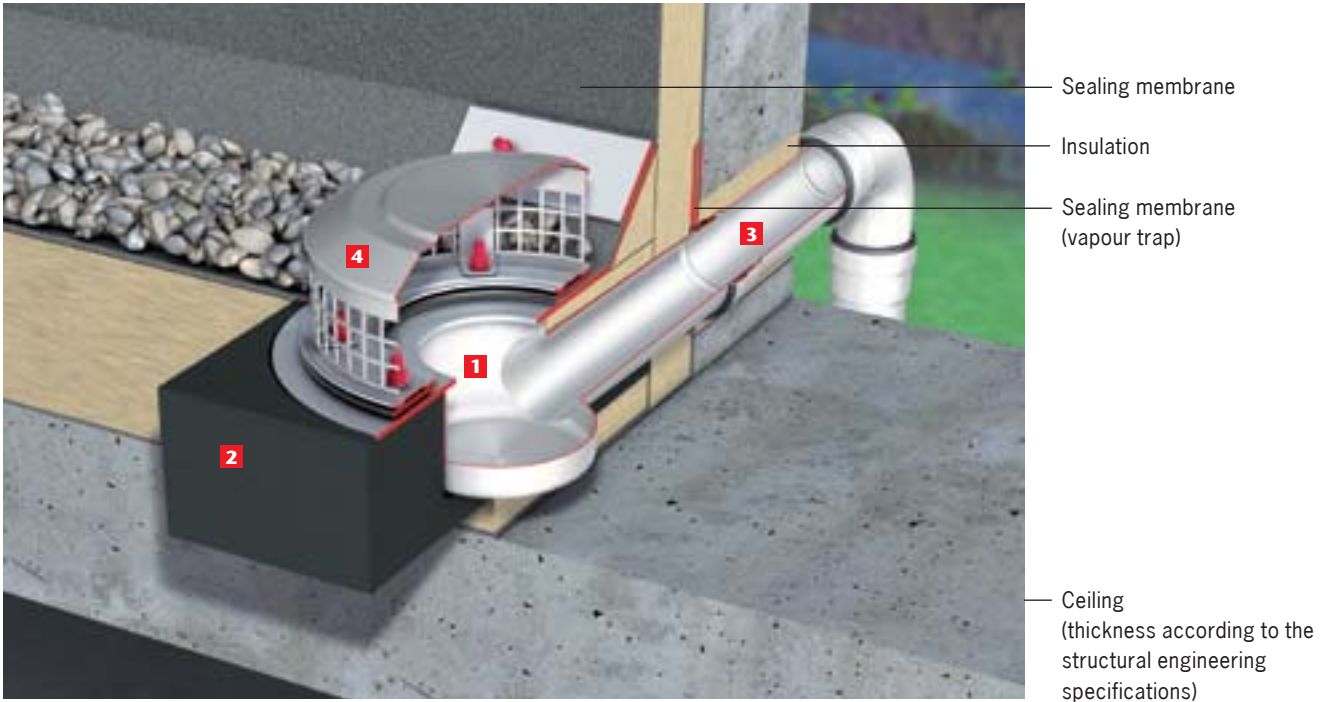

**1** Attika flat roof gully made of stainless steel DN 70, 1.5° socket outlet inclination for sealing with bitumen  
Article No. 0174.78.22

**2** Isolating body  
Article No. 0154.02.94

**3** Attika duct DN 70  
Article No. 0174.48.66

**4** Gravel bucket of stainless steel  
Article No. 0174.46.59

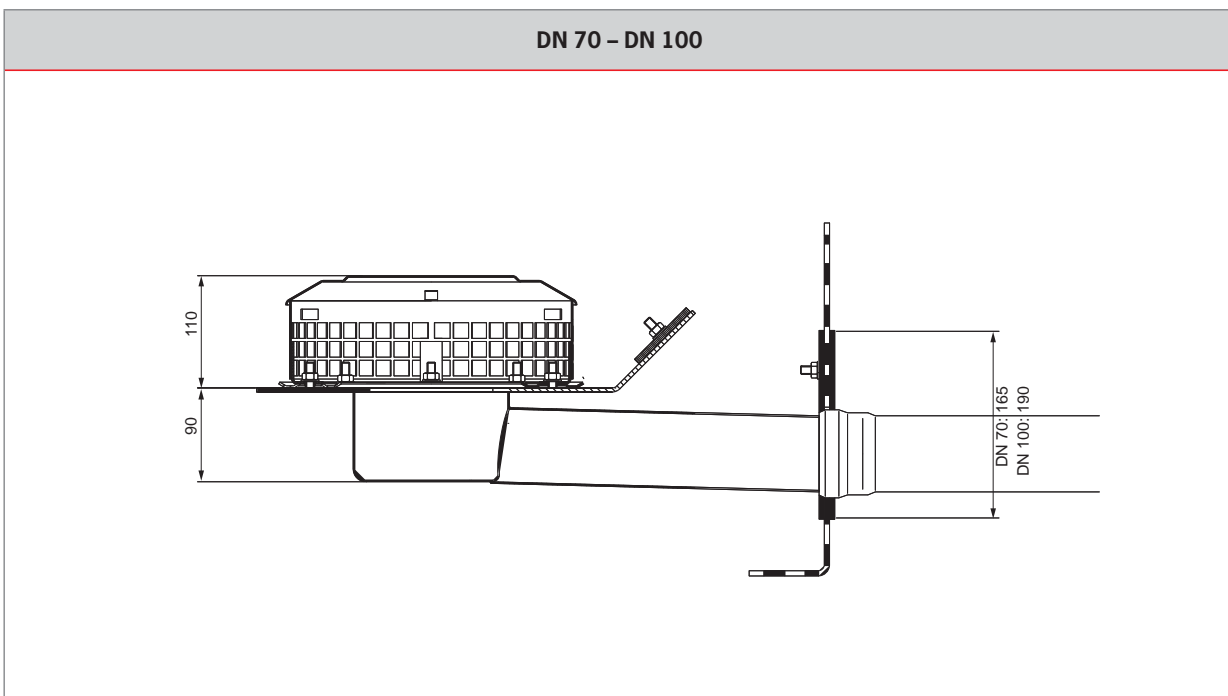

Extension heights in mm

## Attika flat roof drains made of stainless steel

### DN 70–DN 100



- Drain body DN 70 or DN 100
- Stainless steel, material 1.4301
- With compression sealing flange
- Direct connection to ACO GM-X pipe system, connection to other types of pipe requires transition fittings see page 162 and 163

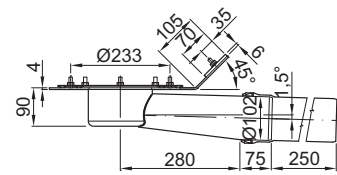
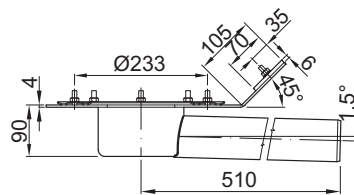

#### For bitumen sealing membranes

Nominal width	DN 70	DN 100
Article No.	<b>0174.78.22</b>	<b>0174.78.24</b>

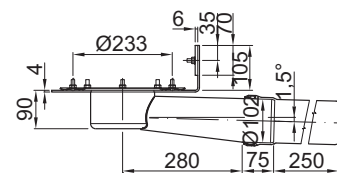
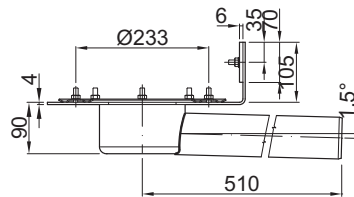

#### For plastic sealing membranes

Nominal width	DN 70	DN 100
Article No.	<b>0174.78.23</b>	<b>0174.78.25</b>

#### Outflow capacities

Nominal width	Pursuant to DIN (l/s)	With 75 mm impoundment (l/s)
DN 70	5,7	16,9
DN 100	6,0	22,0

Additional components

Attika flat roof drains DN 70 – DN 100 made of stainless steel

	Scale drawing	Product description	Model	Article No.
		<b>Stainless steel gravel basket</b> Fits all Spin flat roof drains made of stainless steel	Height: 75 mm Height: 225 mm	<b>0174.46.59</b> <b>0174.46.62</b>
		<b>Plastic gravel basket</b> fits all Spin flat roof drains made of stainless steel		<b>0174.46.66</b>
		<b>Plastic support</b> for plastic gravel basket		<b>0174.46.67</b>
		<b>Flange seal</b> diameter: 303 mm Thickness: 4 mm	EPDM PVC-soft NBR/SBR	<b>0174.42.87</b> <b>0174.42.92</b> <b>0174.42.97</b>
		<b>Impoundment ring</b> for emergency drains, stainless steel, 1.4301, diameter: 324 mm, height: 35 mm		<b>0174.46.76</b>
		<b>Insulating body</b> foam glass	DN 70 DN 100	<b>0154.02.95</b> <b>0154.02.94</b>
		<b>Attika duct</b> DN 100 with pre-installed clamped-in bitumen connecting sleeve	DN 70 DN 100	<b>0174.48.66</b> <b>0174.48.67</b>

Installation recommendation

Multiflex flat roof duct made of stainless steel



- Gravel layer
- Sealing membrane
- Thermal insulation
- Sealing membrane (vapour trap)
- Trapezoidal sheet metal roof

**1** Multiflex flat roof duct DN 100  
With rain cap and two flanges  
Article No. 0174.43.05

**2** GM-X pipe

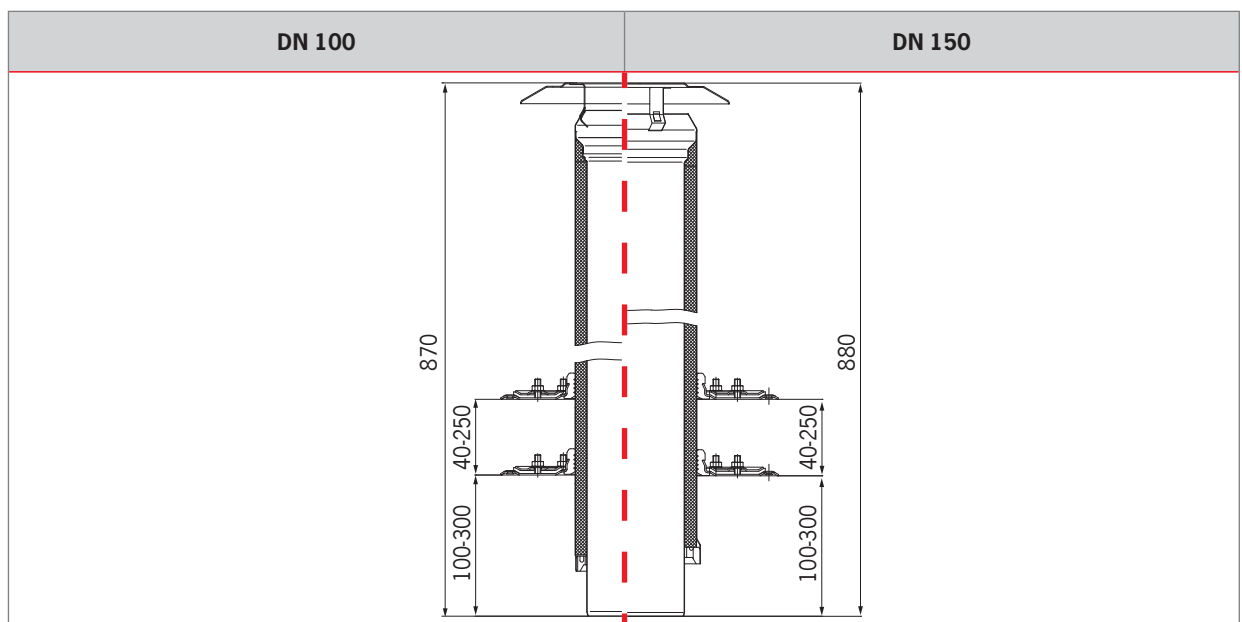

Extension heights in mm

## Multiflex flat roof duct made of stainless steel

### DN 100 or DN 150



- Flat roof duct DN 100 or DN 150
- Stainless steel, material 1.4301
- Thermally insulated model
- Optional with one or two height adjustable compression sealing flanges
- Optional with or without rain cap
- Direct connection to ACO GM-X pipe system, connecting to other types of pipe requires transition fittings, see pages 162 and 163

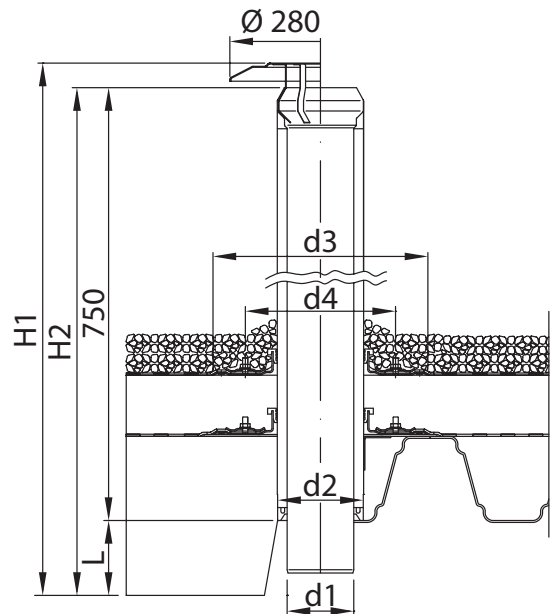

$d_3$  = external flange diameter  
 $d_4$  = bolt circle diameter, z minus number of bolts  
 $d_2$  = outer sleeve minus diameter  
 $d_1$  = pointed end minus diameter

Nominal width	Number of flanges	Model	$d_1$	$d_2$	$d_3$	$d_4$	L	z	$H_1$	$H_2$	Weight	Article No.
DN 100 or DN 70*	1	with rain cap	102	133	332	233	80	8 x M8	870	830	6	0174.43.01
	2	with rain cap									8	0174.43.05
	1										5	0174.43.09
	2										7	0174.43.13
DN 150 or DN 100**	1	with rain cap	159	192	410	300	90	10 x M8	880	840	8	0174.43.03
	2	with rain cap									11	0174.43.07
	1										7	0174.43.11
	2										10	0174.43.15

\*The following components must be ordered for a DN 70 duct:  
 Duct DN 100 according to the previous table plus GM-X adapter piece art. no. 0174.12.73 plus GM-X sealing ring art. no. 0174.14.71

\*\*The following components must be ordered for a DN 125 duct:  
 Duct DN 150 according to the previous table plus GM-X adapter piece art. no. 0174.12.76 plus GM-X sealing ring art. no. 0174.14.74